

Map/Directions to Specialty Care Clinic, Imaging, Outpatient Services

Option 1: Drive to Specialty Care Clinic /Outpatient Services patient parking lot.

Driving directions (red arrows →):

- 1) Head east to Mueller Blvd, away from hospital.
- 2) Take a right onto Mueller Blvd.
- 3) Take a right onto Philomena St.
- 4) Turn right into the Outpatient Services patient lot (gate will automatically rise).

Option 2: Walk from main entrance, outside of building.

Walking directions (blue dotted line . . .):

- 1) Exit main entrance, head right around circle drive.
- 2) Take staircase on your right down to lower level.
- 3) Continue walking South around building until you see Imaging and Specialty Clinic double doors (D&E on map)

Option 3: Walk through hospital to clinic. (see back for map and directions)



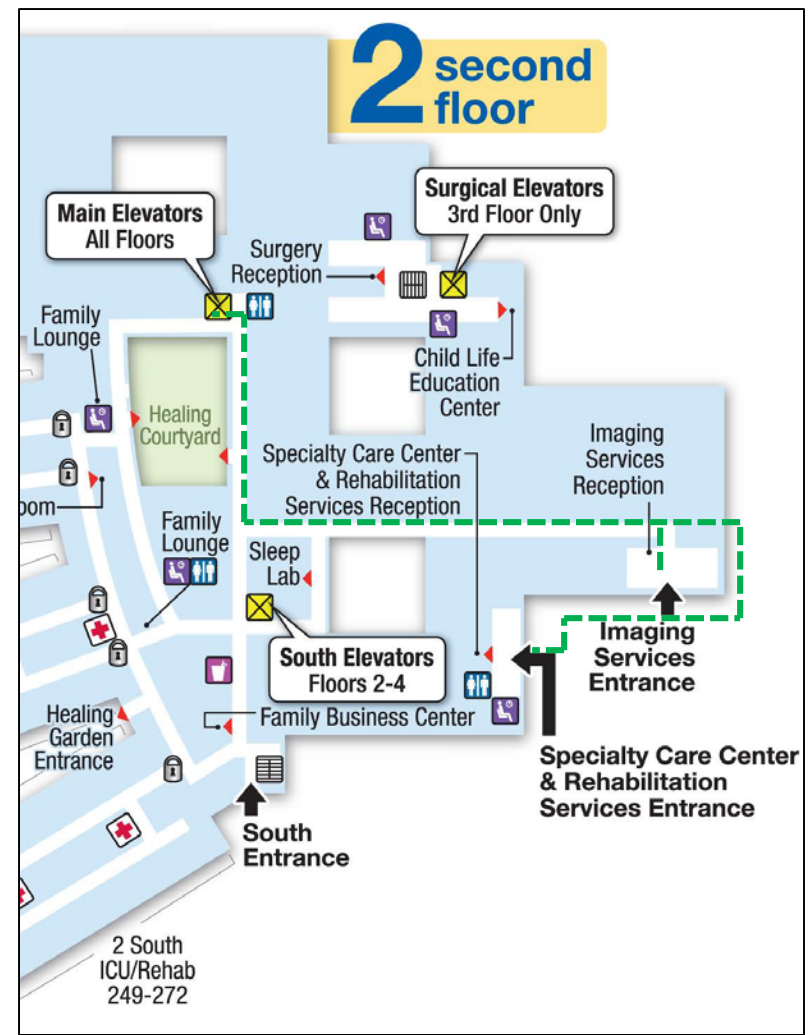

Walking directions through hospital (green dotted line **---**):

- 1) From main entrance, head straight towards the information desk and take the main elevators down to the 2nd floor.
- 2) Exit elevator bank and take a right down the long hallway alongside the Healing Courtyard.
- 3) Take your first left down another long hallway towards Imaging.
- 4) For Imaging Services, take a right at the very end of the hallway into the Imaging Services Reception area.
- 5) For Specialty Care Clinic, exit through door at end of hallway.
- 6) Take a right, and then another right around building to enter Specialty Care Clinic from exterior doors.